

Insert Bits

Slotted Drive

Extra Hard

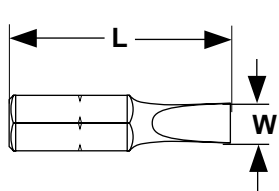

INSERT BIT

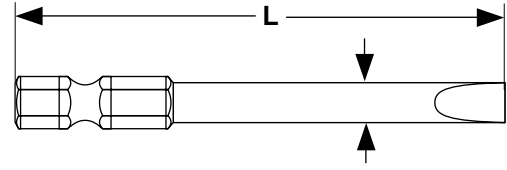
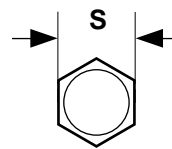
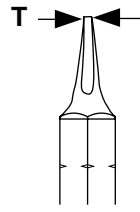

POWER BIT

SLOTTED INSERT BITS •E XTRA HARD							Magna™, Apex®*	
Part Numbers			Screw Size	S	L	T	W	
Kanebridge	Apex®	Magna™		Shank (A.F.)	Overall Length	Blade Thickness	Blade Width	
27-001	445-2-15	27001	6 - 8	1/4	1-1/2	.040	.250	
27-002	445-3-15	27002	8 - 10	1/4	1-1/2	.042	.281	
27-003	445-4-15	27003	10 - 12	1/4	1-1/2	.046	.281	
39-534	445-10	39534	4 - 5	1/4	1	.034	.187	
39-535	445-20	39535	5 - 6	1/4	1	.036	.218	
39-536	445-2	39536	6 - 8	1/4	1	.040	.250	
39-537	445-3	39537	8 - 10	1/4	1	.042	.281	
39-538	445-4	39538	10 - 12	1/4	1	.046	.281	
39-539	-	39539	12 - 14	1/4	1	.050	.281	
41-175	-	41175	0 - 1	1/4	1	.024	.109	
41-176	445-000	41176	1 - 2	1/4	1	.026	.125	
41-177	445-00	41177	2 - 3	1/4	1	.028	.140	
41-178	445-0	41178	3 - 4	1/4	1	.032	.156	

SLOTTED POWER BITS •E XTRA HARD							Magna™, Apex®*	
Part Numbers			Screw Size	S	L	T	D	
Kanebridge	Apex®	Magna™		Shank (A.F.)	Overall Length	Blade Thickness	Body Diameter	
27-461	320-00	27461	2 - 3	1/4	1-15/16	.028	.134	
27-462	320-0	27462	3 - 4	1/4	1-15/16	.032	.154	
27-463	320-1	27463	4 - 5	1/4	1-15/16	.034	.187	
27-464	320-2	27464	5 - 6	1/4	1-15/16	.036	.215	
27-465	320-3	27465	6 - 7	1/4	1-15/16	.038	.250	
27-466	320-4	27466	8 - 10	1/4	1-15/16	.042	.275	
27-467	320-5	27467	10 - 12	1/4	1-15/16	.046	.312	
27-468	320-6	27468	12 - 14	1/4	1-15/16	.050	.360	

*Bits meet the same dimensions as those published by the manufacturers of the Apex® and Magna™ brands.

Applications/Advantages	Slotted bits require less downward pressure to drive parts than those with cross-recessed openings. It is important to choose the proper fitting blade to minimize slippage. Power bits are for use with power drivers. Insert bits are used with hand drivers, or may be used in power drivers when inserted into a bit holder. Extra hard bits are used specifically with case hardened screws.
Material	Chrome vanadium tool steel
Hardness	Rockwell C 59 - 62.

®Apex is a registered trademark of Cooper Industries.

™Magna is a division of Vermont American Corporation.

Kanebridge's insert and power bits are not manufactured by or connected with the producers of Apex® and Magna™ bits.