

**NUTS**

**DIN 557 Square Nuts**

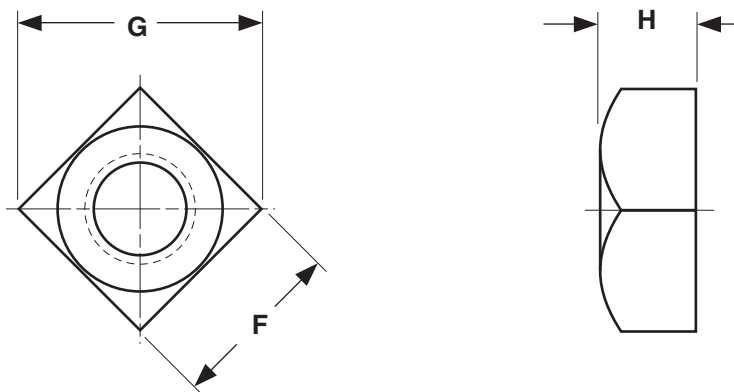

<b>DIN 557 SQUARE NUTS</b>			
<b>Nominal Diameter and Thread Pitch</b>	<b>F</b>	<b>G</b>	<b>H</b>
	<b>Width Across Square</b>	<b>Width Across Corners</b>	<b>Thickness</b>
	<b>Ref</b>	<b>Min</b>	<b>Ref</b>
M5 - 0.80	8	11.30	4
M6 - 1	10	14.10	5
M8 - 1.25	13	18.40	6.5
M10 - 1.50	17	24	8
M12 - 1.75	19	26.90	10
M16 - 2	24	33.90	13
M20 - 2.5	30	42.40	16

<b>Description</b>	A four-sided, internally threaded fastener with a flat bottom side and a chamfered, washer-crowned top.
<b>Applications/ Advantages</b>	Designed for use with square bolts.
<b>Material</b>	A2 Stainless Steel
<b>Plating</b>	Stainless square nuts are typically supplied without any additional finish.