

WASHERS

DIN 125A Flat

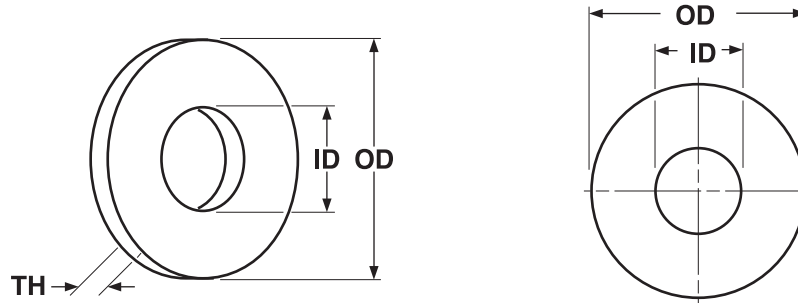

METRIC - STANDARD FLAT WASHERS, PER DIN 125A

DIN 125A

Nominal Size	ID		OD		T	
	Internal Diameter		Outside Diameter		Thickness	
	Max	Min	Max	Min	Max	Min
M2	2.34	2.2	5	4.7	0.35	0.25
M2.5	2.84	2.7	6	5.7	0.55	0.45
M3	3.38	3.2	7	6.64	0.55	0.45
M3.5	3.88	3.7	8	7.64	0.55	0.45
M4	4.48	4.3	9	8.64	0.9	0.7
M5	5.48	5.3	10	9.64	1.1	0.9
M6	6.62	6.4	12	11.57	1.8	1.4
M8	8.62	8.4	16	15.57	1.8	1.4
M10	10.77	10.5	20	19.48	2.2	1.8
M12	13.27	13	24	23.48	2.7	2.3
M14	15.27	15	28	27.48	2.7	2.3
M16	17.27	17	30	29.48	3.3	2.7
M20	21.33	21	37	36.38	3.3	2.7
M24	25.33	25	44	43.38	4.3	3.7

Description	A thin, flat circular part with a centrally located hole with outside diameter approximately twice the nominal thread diameter of the bolt or screw to be used with it. The "A" in 125A denotes that this washer is not chamfered.		
Applications/Advantages	This is the most commonly used flat washer with low carbon bolts, screws and nuts.	Can be used with medium carbon steel bolts, screws and nuts	Suitable for use with A2 (18-8) stainless steel screws, bolts and nuts.
Material	Steel HV-140	Steel HV-200	A2 Stainless HV-140
Hardness	HV 140 - 250	HV 200 - 300	HV 140 min.
Plating	See Appendix-A for information about the plating of flat washers.		Stainless flat washers are typically supplied plain or with black oxide finish.